

# PRESSURE VACUUM BREAKER - MODEL 765

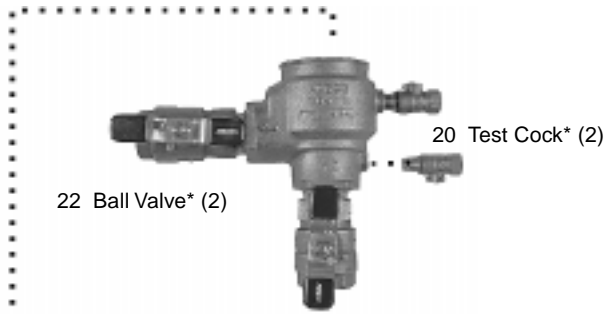
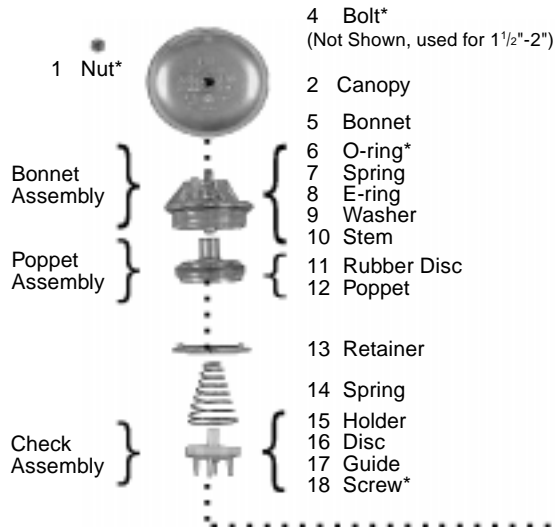

Illustration shown is for sizes 3/4" through 1 1/4" only.

Bonnet and bolt for 1 1/2" and 2" not shown.

\* COMMERCIAL PARTS

Fig. No.	Description	Quantity	765 1/2"	765 3/4"	765 1"	765 1 1/4"	765 1 1/2"	765 2"
1	Nut		523-533-00	523-533-00	523-543-00	523-543-00	523-543-00	523-543-00
2	Canopy		300-092	300-093	300-089	300-090	300-094	300-093
4	Bolt	6	-	-	-	-	511-514-06	511-514-06
6	O-Ring		398-026-72	398-026-72	398-140-72	398-140-72	398-247-72	398-247-72
7	Spring		-	-	-	-	630-096	630-096
10	Stem		-	-	-	-	200-767	200-767
13	Retainer		300-096	300-096	300-088	300-088	-	-
14	Spring		630-108	630-108	630-106	630-106	630-063	630-063
20	Test Cock	2	781-074	781-074	781-075	781-075	781-075	781-075
22	Ball Valve	2	781-047	781-048	781-049	781-050	781-051	781-052
<b>Part Kits</b>								
	Rubber Parts Kit (6, 11, 16)		905-020	905-020	905-021	905-021	905-022	905-022
	Bonnet Assembly (5-10)		905-047	905-047	905-048 <sup>(2)</sup>	905-048 <sup>(2)</sup>	-	-
	Bonnet/Kit (3, 5-10)		-	-	-	-	901-857	901-857
	Poppet Assembly (11,12)		905-049	905-049	905-050	905-050	901-860	901-860
	Check Assembly (15-18)		905-051	905-051	905-052	905-052	-	-
	Check Repair Kit (6, 13, 15-18)		-	-	-	-	905-070	905-070
	Bonnet/Poppet Kit (5-12)		905-211	905-211	905-212 <sup>(2)</sup>	905-212 <sup>(2)</sup>	-	-

(2) Kit includes parts to retrofit older style units